



H.E. Anderson
COMPANY
 Muskogee, OK. 74402-1006
 (918) 687-4426

NAME: MANIFOLD PARTS TYPE A ELECTRIC

DATE: 5/7/2014

Proprietary Rights Apply To The Subject Shown And Are Property Of H.E. Anderson Co., Inc.

MANIFOLD ASSY PART NUMBERS

QTY	PUMPER	24VAC	12VDC
1	PUMPER	42121	42065
2	PUMPER	42132S	42076S
3	PUMPER	42143S	42087S
4	PUMPER	42154S	42098S
5	PUMPER	42165S	42109S
6	PUMPER	42176S	42110S

DOTTED PARTS
 NOT INCLUDED
 WITH MANIFOLD

INCLUDED WITH
 PUMPER

PILOT VALVE
 18665 24VAC
 18654 12VDC

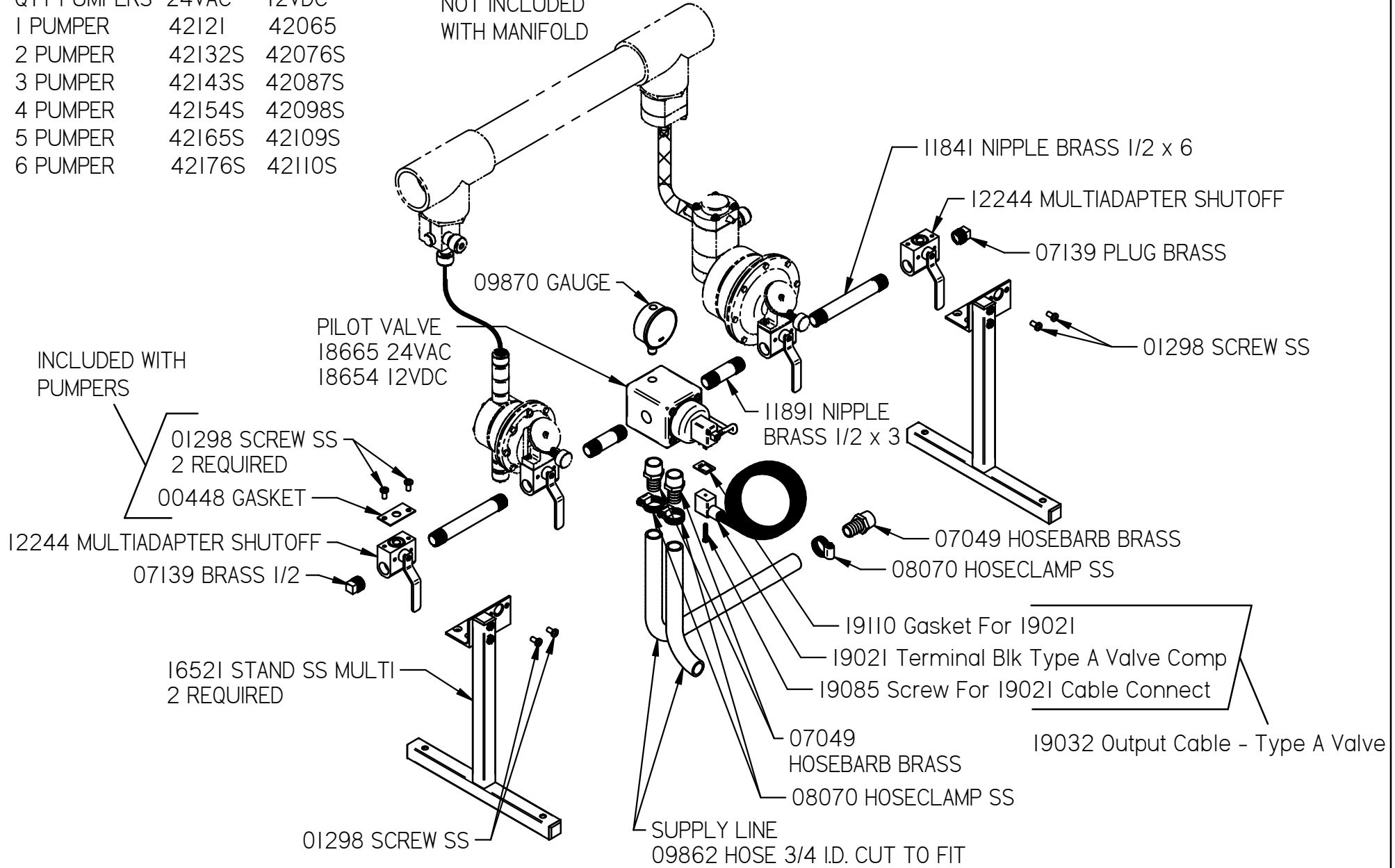

01298 SCREW SS
 2 REQUIRED
 00448 GASKET

12244 MULTIADAPTER SHUTOFF
 07139 BRASS 1/2

16521 STAND SS MULTI
 2 REQUIRED

01298 SCREW SS

09870 GAUGE

11891 NIPPLE
 BRASS 1/2 x 3

11841 NIPPLE BRASS 1/2 x 6

12244 MULTIADAPTER SHUTOFF

07139 PLUG BRASS

01298 SCREW SS

07049 HOSEBARB BRASS

08070 HOSECLAMP SS

19110 Gasket For 19021
 19021 Terminal Blk Type A Valve Comp
 19085 Screw For 19021 Cable Connect

07049
 HOSEBARB BRASS

08070 HOSECLAMP SS

19032 Output Cable - Type A Valve

SUPPLY LINE
 09862 HOSE 3/4 I.D. CUT TO FIT